

Presentation to Joint Education Committee

Demetrus Liggins, PhD
August 20, 2024

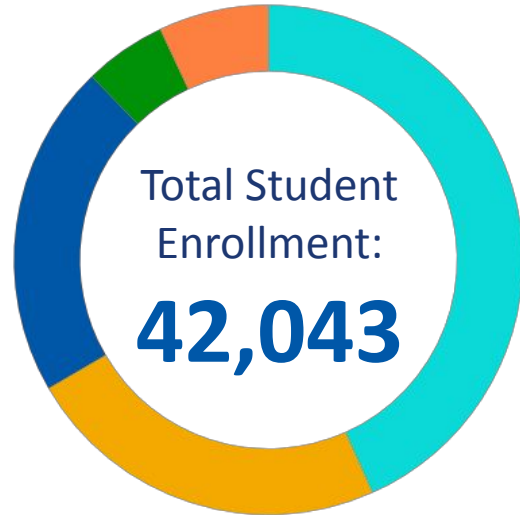

Our Students



White:
43.3%



Black:
23.3%



Hispanic:
21.2%



Asian:
5.2%



Other:
7%



Students who qualify for free or reduced lunch: **51.2%**

Students identified as gifted and talented: **13%**

Students receiving EL services: **17%**

Students identified for special education: **13%**

Students experiencing homelessness: **1.7%**



Our Schools

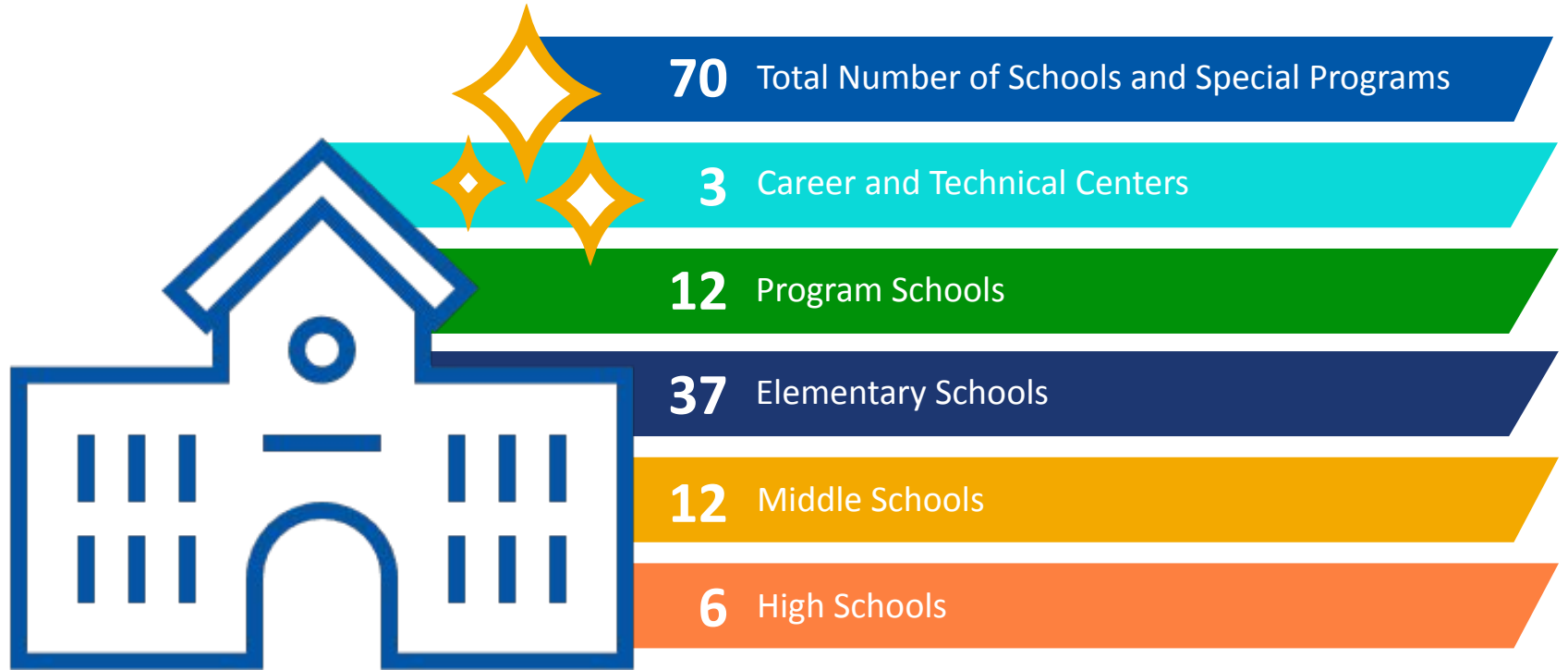



From 2007 to 2022

\$199.5 MILLION GENERATED = \$658 MILLION BONDED

131+ ACRES SECURED FOR FUTURE PROJECTS



7

NEW SCHOOL BUILDINGS

23

SCHOOL BUILDINGS MODERNIZED AND TRANSFORMED



3

NEW SUPPORT FACILITIES

RETURN ON INVESTMENT: \$1.6 Billion
in today's dollars invested in local construction

FUNDED SROs, counselors, and secure entrances at all campuses



Innovative Offerings

New Magnet Programs in the past 11 years:

- ★ Success Academy
- ★ STEAM Academy
- ★ CGW Prep
- ★ CGWA
- ★ Biomedical sciences
- ★ Locust Trace Ag Ctr.
- ★ Opportunity Middle College
- ★ Virtual Learning Academy
- ★ The Stables
- ★ Rise STEM for Girls
- ★ School-Based Partial Hospitalization Program





Key Considerations



Safety



Academics



Efficiency



Compliance

Living Lab Teams





Built to Last

After 15 years, the following is allowable:

- Heating, Ventilation and Air Conditioning Systems and Controls
- ADA Compliance
- Life Safety and Security Systems
- Roofing Systems, Flashings and Accessories

After 30 years, a major renovation is allowable:

- Including three or more building systems and an estimated cost of 20% of the current replacement cost of the building, or portion thereof.
- The building shall be a minimum of 30 years old or 30 years shall have passed since its last major renovation with the exception of restructuring an open space school for conventional classrooms.

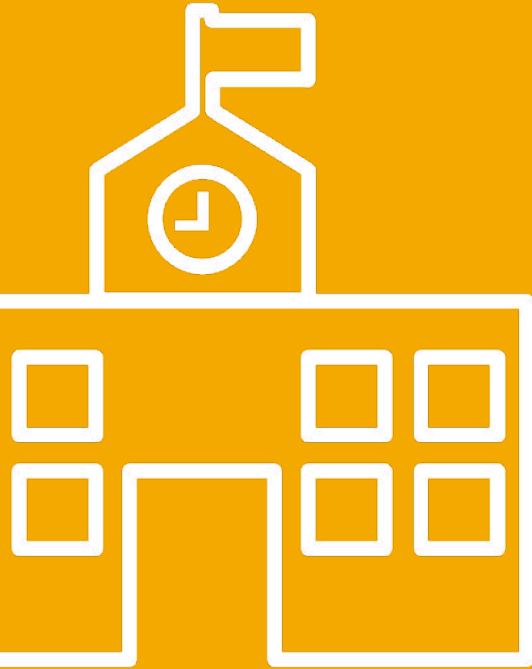



Central Ky. schools dealing with vandalism linked to latest viral TikTok 'challenge'



LEXINGTON SCHOOLS VANDALIZED
IN TIKTOK CHALLENGE

WKYT

6:11 | 80°

Licks getting outa hand

Central Ky. schools dealing with vandalism linked to latest viral TikTok 'challenge'

**Total
Damage:
\$42,579**



E-Cigarettes were the most popular tobacco product for the 10th year in a row



Current tobacco use **increased** among middle school students

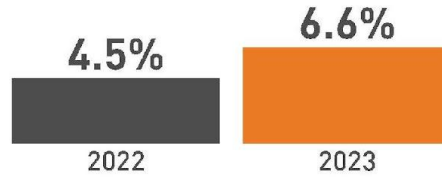

More than **2.1 million youth** currently used e-cigarettes

Among youth who reported current use of e-cigarettes:

More than **1 in 4**



used e-cigarettes daily

The most commonly reported brands were:



Almost **9 out of 10**



used flavored e-cigarettes

Findings from the National Youth Tobacco Survey 2023



2022-23 Safe Schools Annual Statistical Report

Office of Continuous Improvement and Support

November 2023



Kentucky Department of Education
Office of Continuous Improvement and Support
Division of Student Success
(502) 564-4772

“Incidents reported to have taken place in the restroom rose significantly. The most common events to have been reported in restrooms include tobacco use, tobacco possession, fighting and drug possession.”

-2022-23 Safe Schools Annual Statistical Report



Behavior Events by Location

	2018-19	2022-23	Percent Difference	2018-19	2022-23	Percent Difference
	State	State	State	FCPS	FCPS	FCPS
Classroom	240,049	165,832	-31%	26,048	24,788	-5%
Hallway/ Stairwell	20,100	44,601	+122%	2,766	8,199	+196%
Restroom	4,980	15,669	+215%	340	1,416	+316%



District Safety Advisory Council Recommendations

- Middle School Focus
- Supervision in Bathrooms and Hallways
- Vape, THC, Noise Detectors
- Evaluate individual “stall” bathrooms

**BY THE
NUMBERS**

43%

*of students fear harassment
in the bathroom at school*

50%

*more restrooms
available in
individual bathroom
configurations*

80%

*of educators agreed
that bullying,
misbehavior,
vandalism, and other
negative behavior
occurs in bathrooms*

17%

*of Kentucky middle and high
school students feel unsafe in
bathrooms*

Bathroom Layouts

Traditional Layout

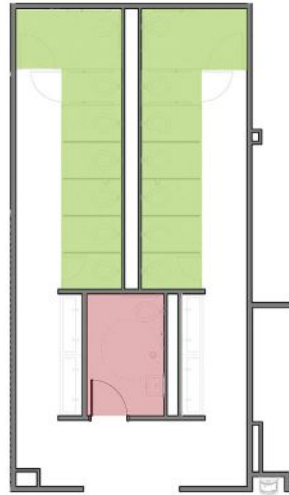

Enclosed ADA toilet rooms

Traditional stalls and doors

Individual Restroom Layout

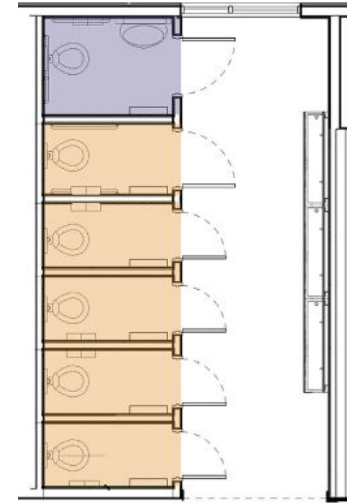

Full-height framed wall toilet rooms

Self-contained ADA restroom

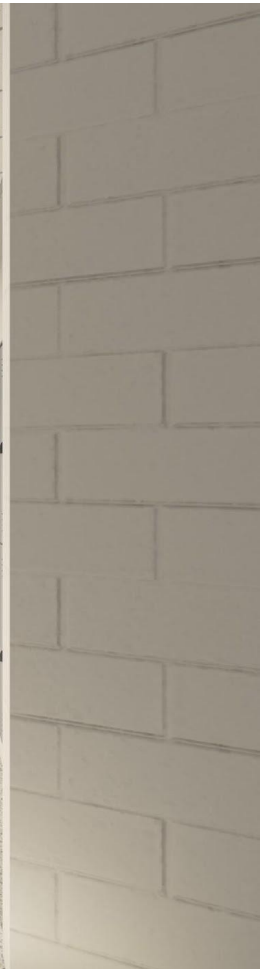





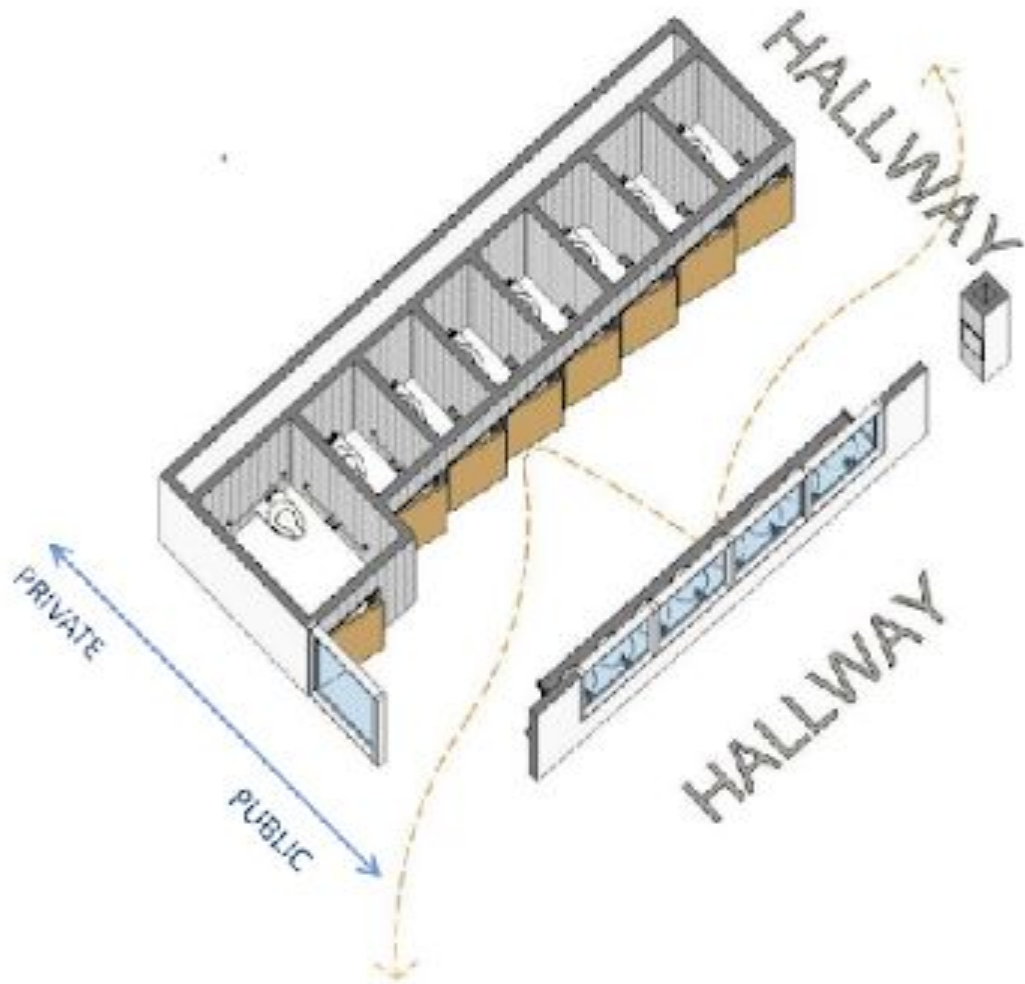





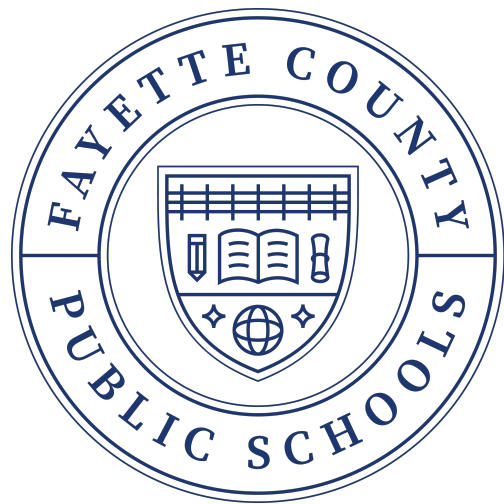

Questions?